

**This electronic collection of documents is provided  
for the convenience of the user  
and is Not a Certified Document –**

**The documents contained herein were originally issued  
and sealed by the individuals whose names and license  
numbers appear on each page, on the dates appearing  
with their signature on that page.**

**This file or an individual page  
shall not be considered a certified document.**

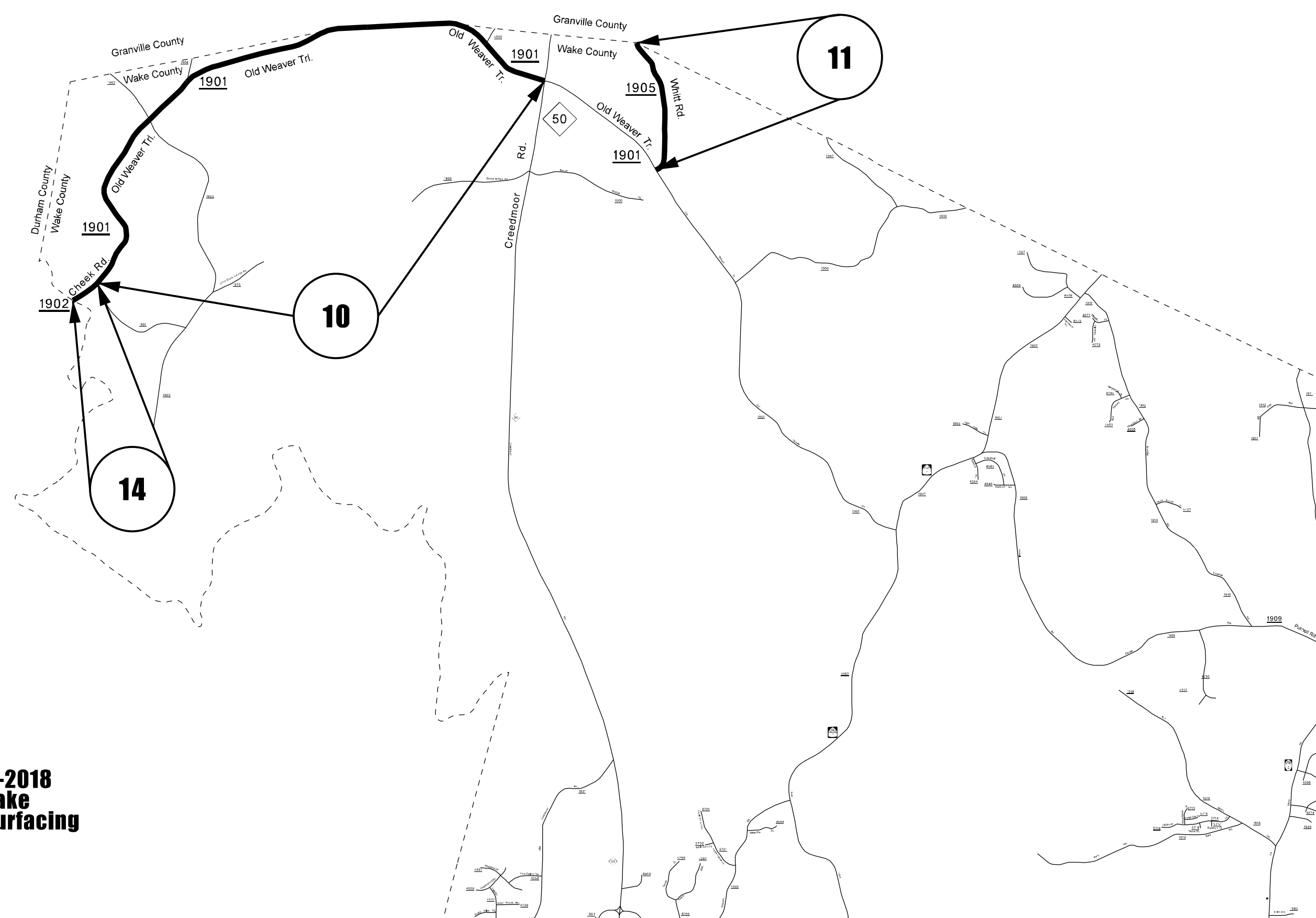

**2017-2018  
Wake  
Microsurfacing**

5/14/19

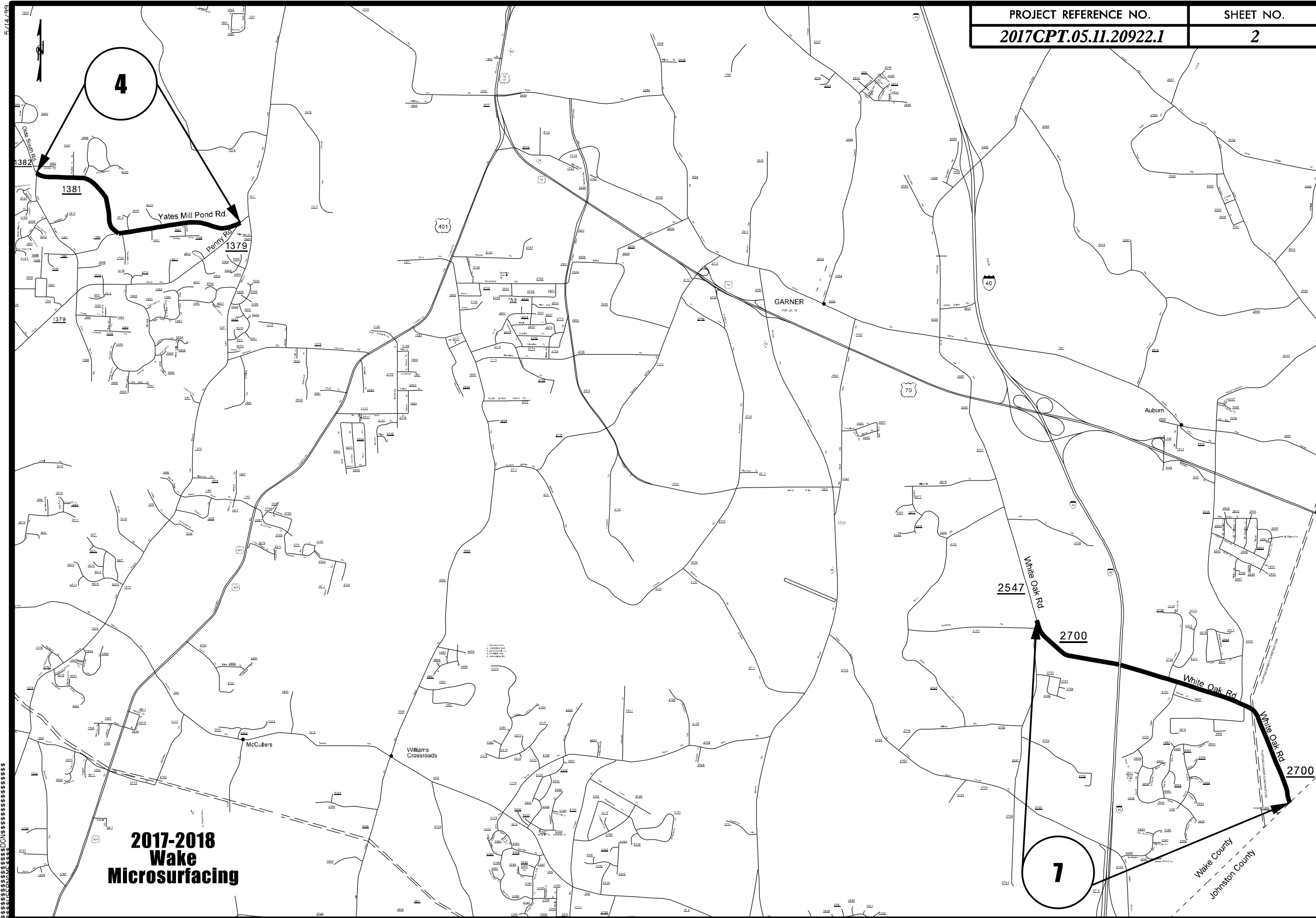

**4**

1381

Yates Mill Pond Rd

Penny Rd

1379

1379

GARNER  
POP. 20,115

70

Auburn

2547

White Oak Rd

2700

White Oak Rd

White Oak Rd

2700

**7**

Wake County  
Johnston County

**2017-2018  
Wake  
Microsurfacing**

5/14/19  
C:\PROJECTS\2017-2018 WAKE MICROSURFACING\2017-2018 WAKE MICROSURFACING.DWG

5/14/19

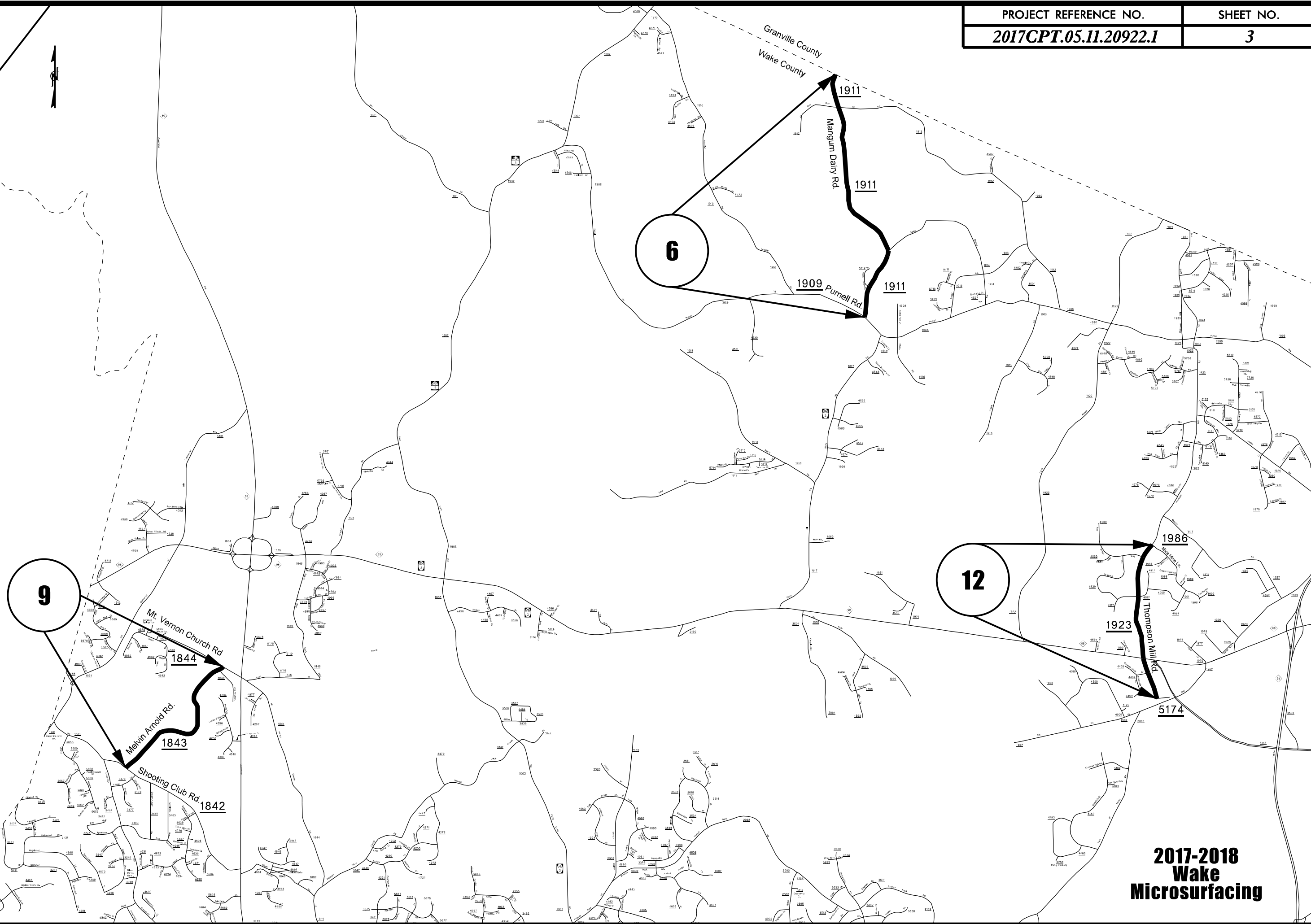

**2017-2018  
Wake  
Microsurfacing**

CONSTRUCTION

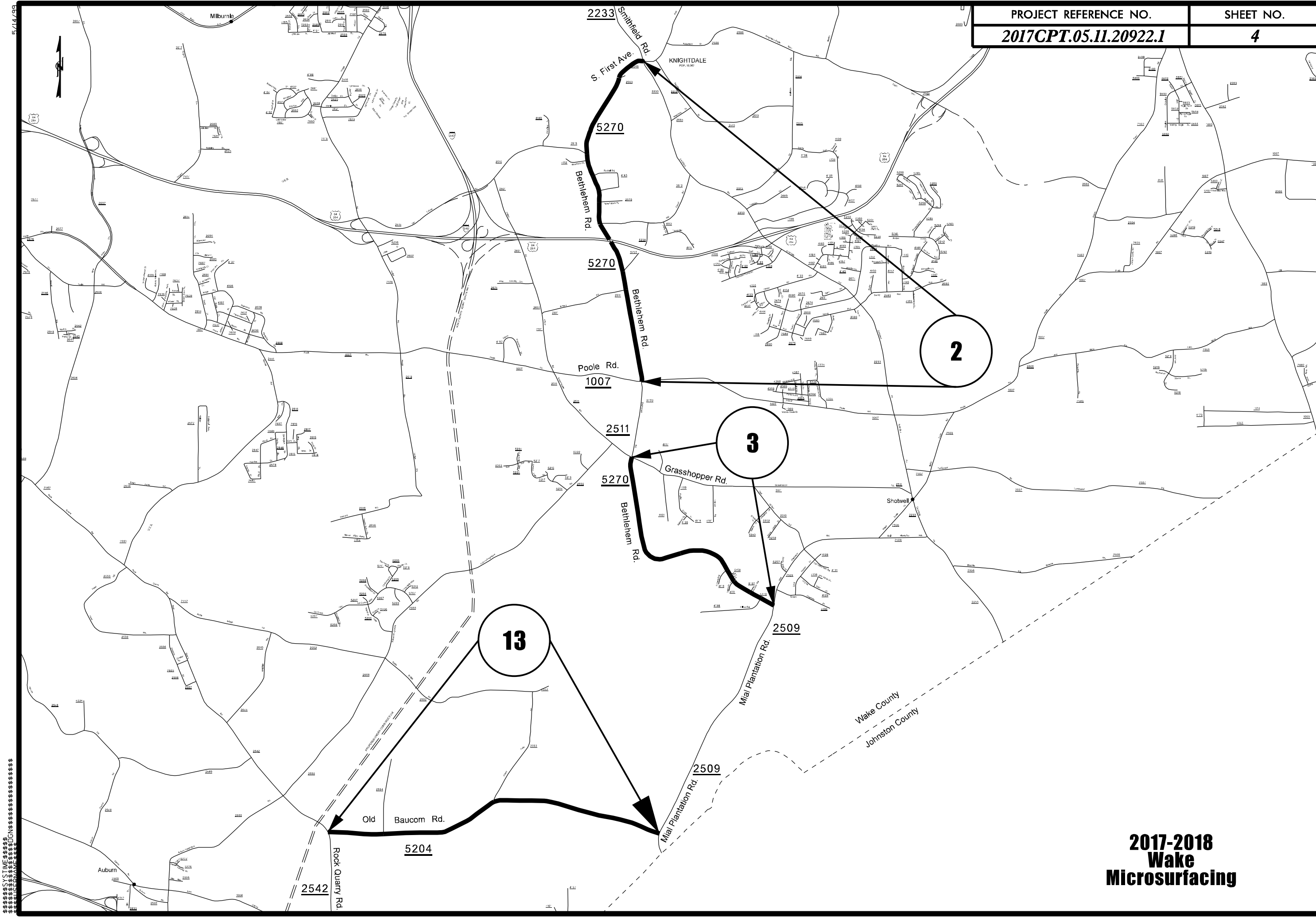

5/14/19  
C:\PROJECTS\2017CPT\2017CPT.05.11.20922.1\2017CPT.05.11.20922.1.dwg

**2017-2018  
Wake  
Microsurfacing**

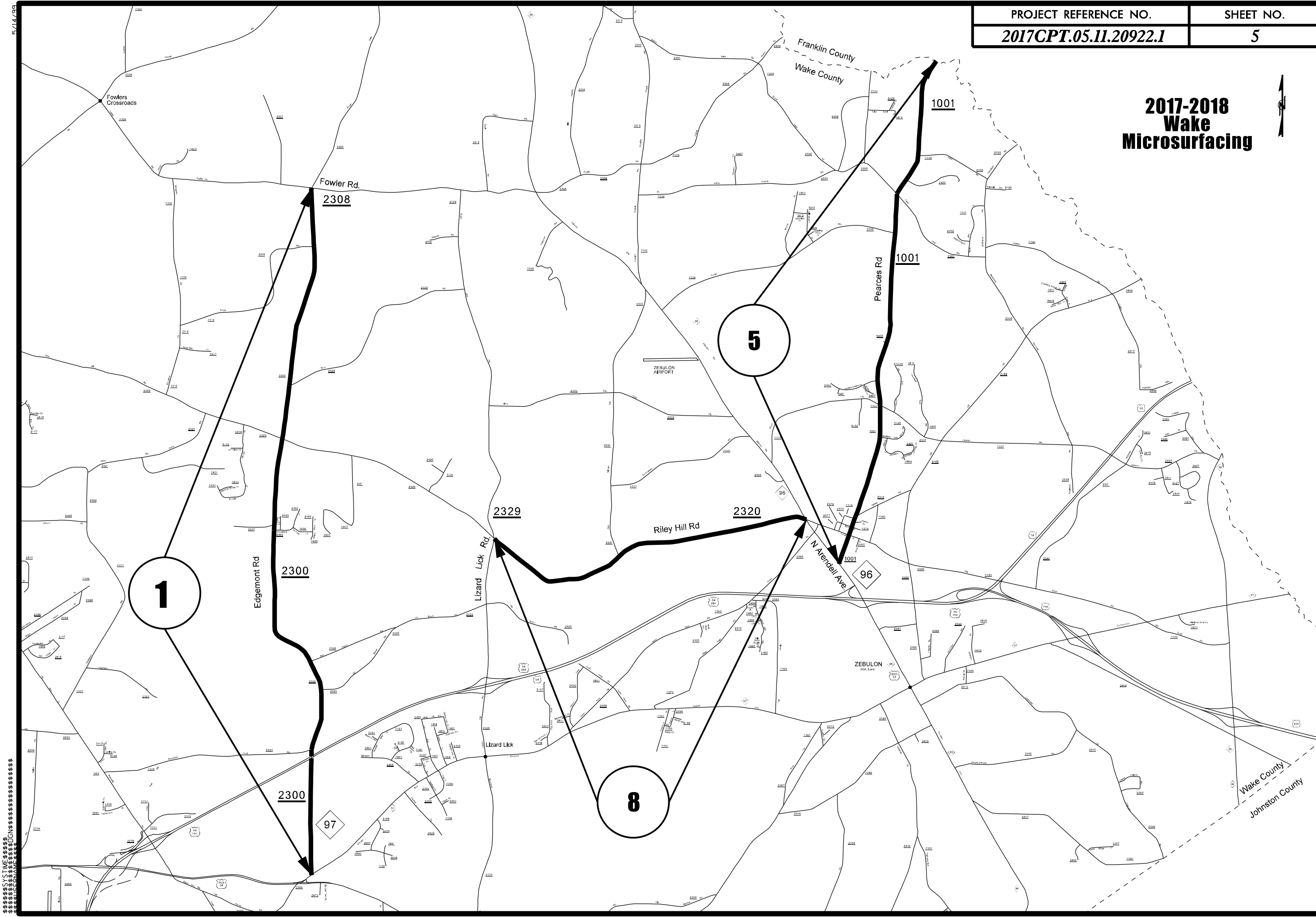

5/14/19  
C:\PROJECTS\2017-2018 WAKE MICROSURFACING\2017-2018 WAKE MICROSURFACING.dwg

# PAVEMENT SCHEDULE

PROJECT REFERENCE NO.  
**2017CPT.05.11.20922.1**

SHEET NO.  
**1**

<b>C</b>	PROP. LATEX MODIFIED MICRO-SURFACING, TYPE III AT AN AVERAGE RATE OF 22 TO 26 LBS. PER SQ. YD.
<b>U</b>	EXISTING PAVEMENT

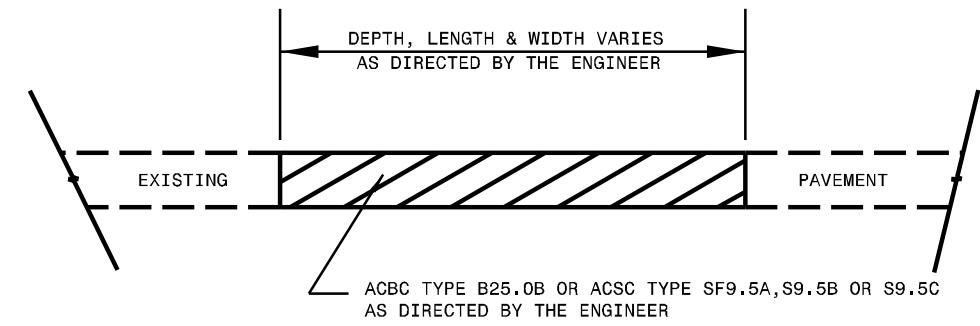

**PATCHING EXISTING PAVEMENT**  
MILLING TO BE PERFORMED PRIOR TO PATCHING

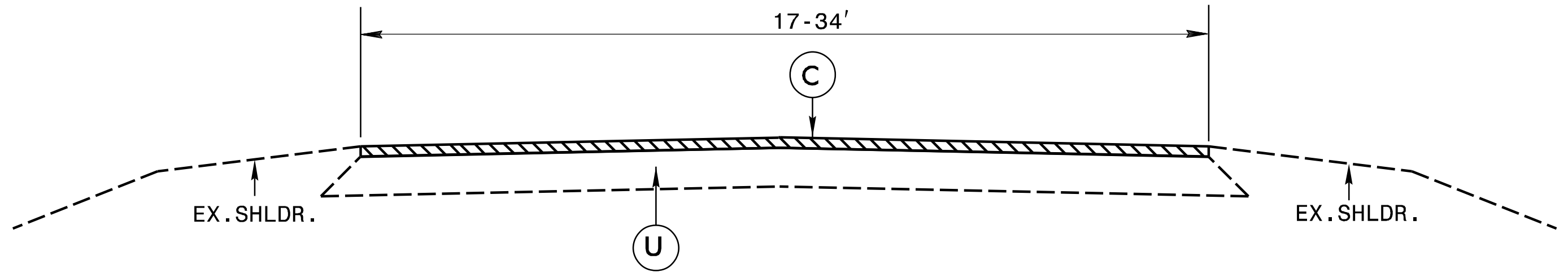

TYPICAL SECTION 1

PROJECT NO.	SHEET NO.	TOTAL NO.
2017CPT.05.11.20922.1		

## SUMMARY OF QUANTITIES

PROJECT NO	COUNTY	MAP NO	ROUTE	DESCRIPTION	TYP NO	LANES	LANE TYPE	FINAL SURFACE TESTING REQUIRED	WARM MIX ASPHALT REQUIRED	LENGTH MI	WIDTH FT	PATCHING EXISTING PAVEMENT TONS	LATEX MODIFIED MICROSURF ACING, TYPE III SY
2017CPT.05.11.20922.1	Wake	1	SR 2300 - EDGEMONT RD	SR 2308 - FOWLER RD TO NC 97	1	2		NO	NO	5.59	17-34	60	66,780
<b>TOTAL FOR MAP NO. 1</b>										<b>5.59</b>		<b>60</b>	<b>66,780</b>
2017CPT.05.11.20922.1	Wake	2	SR 5270 - S FIRST AVE/BETHLEHEM RD	SR 2233 - SMITHFIELD RD TO SR 1007 - POOLE RD	1	2		NO	NO	2.77	20-34	120	32,501
<b>TOTAL FOR MAP NO. 2</b>										<b>2.77</b>		<b>120</b>	<b>32,501</b>
2017CPT.05.11.20922.1	Wake	3	SR 5270 - BETHLEHEM RD	SR 2511 - GRASSHOPPER RD TO SR 2509 - MIAL PLANTATION RD	1	2		NO	NO	1.97	20	50	23,115
<b>TOTAL FOR MAP NO. 3</b>										<b>1.97</b>		<b>50</b>	<b>23,115</b>
2017CPT.05.11.20922.1	Wake	4	SR 1381 - YATES MILL POND RD	SR 1379 - PENNY RD TO SR 1382 - OLDE SOUTH RD	1	2		NO	NO	1.87	24	45	26,330
<b>TOTAL FOR MAP NO. 4</b>										<b>1.87</b>		<b>45</b>	<b>26,330</b>
2017CPT.05.11.20922.1	Wake	5	SR 1001 - PEARCES RD	FRANKLIN COUNTY - TO NC 96 - N ARENDELL AVE	1	2		NO	NO	4.11	18-34	120	50,635
<b>TOTAL FOR MAP NO. 5</b>										<b>4.11</b>		<b>120</b>	<b>50,635</b>
2017CPT.05.11.20922.1	Wake	6	SR 1911 - MANGUM DAIRY RD	SR 1909 - PURNELL RD TO GRANVILLE COUNTY	1	2		NO	NO	2.09	20	20	24,523
<b>TOTAL FOR MAP NO. 6</b>										<b>2.09</b>		<b>20</b>	<b>24,523</b>
2017CPT.05.11.20922.1	Wake	7	SR 2700 - WHITE OAK RD	SR 2547 - WHITE OAK RD TO JOHNSTON COUNTY	1	2		NO	NO	2.6	22-34	60	36,799
<b>TOTAL FOR MAP NO. 7</b>										<b>2.6</b>		<b>60</b>	<b>36,799</b>
2017CPT.05.11.20922.1	Wake	8	SR 2320 - RILEY HILL RD	SR 2329 - LIZARD LICK RD TO NC 96 - N ARENDELL AVE	1	2		NO	NO	2.69	20	160	31,563
<b>TOTAL FOR MAP NO. 8</b>										<b>2.69</b>		<b>160</b>	<b>31,563</b>
2017CPT.05.11.20922.1	Wake	9	SR 1843 - MELVIN ARNOLD RD	SR 1842 - SHOOTING CLUB RD TO SR 1844 - MT.VERNON CHURCH RD	1	2		NO	NO	1.28	21	110	15,770
<b>TOTAL FOR MAP NO. 9</b>										<b>1.28</b>		<b>110</b>	<b>15,770</b>
2017CPT.05.11.20922.1	Wake	10	SR 1901 - OLD WEAVER TRL	SR 1902 - CHEEK RD BRIDGE JT TO NC 50 - CREEDMOOR RD	1	2		NO	NO	4.28	22	60	55,241
<b>TOTAL FOR MAP NO. 10</b>										<b>4.28</b>		<b>60</b>	<b>55,241</b>
2017CPT.05.11.20922.1	Wake	11	SR 1905 - WHITT RD	SR 1901 - OLD WEAVER TRL TO GRANVILLE COUNTY	1	2		NO	NO	0.88	22	75	11,358
<b>TOTAL FOR MAP NO. 11</b>										<b>0.88</b>		<b>75</b>	<b>11,358</b>
2017CPT.05.11.20922.1	Wake	12	SR 1923 - THOMPSON MILL RD	SR 5174 - OLD NC 98 HWY TO SR 1986 - MICA MINE LN (SKIP NC 98 INTERSECTION)	1	2		NO	NO	1.32	24	15	18,586
<b>TOTAL FOR MAP NO. 12</b>										<b>1.32</b>		<b>15</b>	<b>18,586</b>
2017CPT.05.11.20922.1	Wake	13	SR 5204 - OLD BAUCOM RD	SR 2509 - MIAL PLANTATION TO SR 2542 - ROCK QUARRY RD	1	2		NO	NO	2.74	24	25	38,579
<b>TOTAL FOR MAP NO. 13</b>										<b>2.74</b>		<b>25</b>	<b>38,579</b>
2017CPT.05.11.20922.1	Wake	14	SR 1902 - CHEEK RD	SR 1901 - OLD WEAVER TRL TO DURHAM CO	1	2		NO	NO	0.14	24	2	1,971
<b>TOTAL FOR MAP NO. 14</b>										<b>0.14</b>		<b>2</b>	<b>1,971</b>
<b>TOTAL FOR PROJ NO. 2017CPT.05.11.20922.1</b>										<b>34.33</b>		<b>922</b>	<b>433,751</b>
<b>GRAND TOTAL</b>										<b>34.33</b>		<b>922</b>	<b>433,751</b>



PROJECT NO.	SHEET NO.	TOTAL NO.
2017CPT.05.11.20922.1		

**THERMOPLASTIC AND PAINT QUANTITIES**

PROJECT NO	COUNTY	MAP NO	ROUTE	DESCRIPTION	TYP	LANES	LANE TYPE	LENGTH	WIDTH	4413000000-E	4457000000-N	4685000000-E	4686000000-E		4695000000-E	4700000000-E	4705000000-E	4710000000-E	4721000000-E		4725000000-E			4770000000-E		
										WORK ZONE ADVANCE/GENERAL WARNING SIGNING SF	TEMPORARY TRAFFIC CONTROL LS	4" X 90 M WHITE THERMO LF	4" X 120 M WHITE THERMO LF	4" X 120 M YELLOW THERMO LF	8" X 90 M YELLOW THERMO LF	12" X 90 M YELLOW THERMO LF	16" X 120 M WHITE THERMO LF	24" X 120 M WHITE THERMO LF	THERMO MSG SCHOOL 120 M EA	THERMO RXR 120 M EA	THERMO LT ARROW 90 M EA	THERMO STR & RT ARROW 90 M EA	THERMO STR ARROW 90 M EA	THERMO LT STR RT ARROW 90 M EA	4" WHITE COLD APPLIED PLASTIC, TYPE II LF	4" YELLOW COLD APPLIED PLASTIC, TYPE II LF
2017CPT.05.11.20922.1	Wake	1	SR 2300 - EDMONT RD	SR 2308 - FOWLER RD TO NC 97	1	2		5.59	17-34	626	0.15	57,727	698	49,386		82		100	12		2				456	456
<b>TOTAL FOR MAP NO. 1</b>										<b>626</b>	<b>0.15</b>	<b>57,727</b>	<b>698</b>	<b>49,386</b>		<b>82</b>		<b>100</b>	<b>12</b>		<b>2</b>			<b>456</b>	<b>456</b>	
2017CPT.05.11.20922.1	Wake	2	SR 5270 - S FIRST AVE/BETHLEHEM RD	SR 2233 - SMITHFIELD RD TO SR 1007 POOLE RD	1	2		2.77	20-34	310	0.07	29,805	697	29,304	48	135	100	80		4	6	3	3		710	710
<b>TOTAL FOR MAP NO. 2</b>										<b>310</b>	<b>0.07</b>	<b>29,805</b>	<b>697</b>	<b>29,304</b>	<b>48</b>	<b>135</b>	<b>100</b>	<b>80</b>		<b>4</b>	<b>6</b>	<b>3</b>	<b>3</b>		<b>710</b>	<b>710</b>
2017CPT.05.11.20922.1	Wake	3	SR 5270 - BETHLEHEM RD	SR 2511 - GRASSHOPPER RD TO SR 2509 - MIAL PLANTATION RD	1	2		1.97	20	221	0.05	21,197	131	16,784				16								
<b>TOTAL FOR MAP NO. 3</b>										<b>221</b>	<b>0.05</b>	<b>21,197</b>	<b>131</b>	<b>16,784</b>				<b>16</b>								
2017CPT.05.11.20922.1	Wake	4	SR 1381 - YATES MILL POND RD	SR 1379 - PENNY RD TO SR 1382 - OLDE SOUTH RD	1	2		1.87	24	209	0.06	19,293	207	19,073												
<b>TOTAL FOR MAP NO. 4</b>										<b>209</b>	<b>0.06</b>	<b>19,293</b>	<b>207</b>	<b>19,073</b>												
2017CPT.05.11.20922.1	Wake	5	SR 1001 - PEARCES RD	FRANKLIN COUNTY - TO NC 96 - N ARENDELL AVE	1	2		4.11	18-34	460	0.12	44,224	426	34,246	32											
<b>TOTAL FOR MAP NO. 5</b>										<b>460</b>	<b>0.12</b>	<b>44,224</b>	<b>426</b>	<b>34,246</b>	<b>32</b>											
2017CPT.05.11.20922.1	Wake	6	SR 1911 - MANGUM DAIRY RD	SR 1909 - PURNELL RD TO GRANVILLE COUNTY	1	2		2.09	20	235	0.06	21,398	168	21,552												
<b>TOTAL FOR MAP NO. 6</b>										<b>235</b>	<b>0.06</b>	<b>21,398</b>	<b>168</b>	<b>21,552</b>												
2017CPT.05.11.20922.1	Wake	7	SR 2700 - WHITE OAK RD	SR 2547 - WHITE OAK RD TO JOHNSTON COUNTY	1	2		2.6	22-34	291	0.08	26,928	494	29,731		116					6				434	434
<b>TOTAL FOR MAP NO. 7</b>										<b>291</b>	<b>0.08</b>	<b>26,928</b>	<b>494</b>	<b>29,731</b>		<b>116</b>				<b>6</b>				<b>434</b>	<b>434</b>	
2017CPT.05.11.20922.1	Wake	8	SR 2320 - RILEY HILL RD	SR 2329 - LIZARD LICK RD TO NC 96 - N ARENDELL AVE	1	2		2.69	20	301	0.07	28,944	25	28,944												
<b>TOTAL FOR MAP NO. 8</b>										<b>301</b>	<b>0.07</b>	<b>28,944</b>	<b>25</b>	<b>28,944</b>												
2017CPT.05.11.20922.1	Wake	9	SR 1843 - MELVIN ARNOLD RD	SR 1842 - SHOOTING CLUB RD TO SR 1844 - MT.VERNON CHURCH RD	1	2		1.28	21	143	0.04	13,773	94	13,773												
<b>TOTAL FOR MAP NO. 9</b>										<b>143</b>	<b>0.04</b>	<b>13,773</b>	<b>94</b>	<b>13,773</b>												
2017CPT.05.11.20922.1	Wake	10	SR 1901 - OLD WEAVER TRL	SR 1902 - CHEEK RD BRIDGE JT TO NC 50 - CREEDMOOR RD	1	2		4.28	22	479	0.12	46,622	199	38,689				26						1		
<b>TOTAL FOR MAP NO. 10</b>										<b>479</b>	<b>0.12</b>	<b>46,622</b>	<b>199</b>	<b>38,689</b>				<b>26</b>					<b>1</b>			
2017CPT.05.11.20922.1	Wake	11	SR 1905 - WHITT RD	SR 1901 - OLD WEAVER TRL TO GRANVILLE COUNTY	1	2		0.88	22	99	0.03	9,293		9,293												
<b>TOTAL FOR MAP NO. 11</b>										<b>99</b>	<b>0.03</b>	<b>9,293</b>		<b>9,293</b>												
2017CPT.05.11.20922.1	Wake	12	SR 1923 - THOMPSON MILL RD	SR 5174 - OLD NC 98 HWY TO SR 1986 - MICA MINE LN (SKIP NC 98 INTERSECTION)	1	2		1.32	24	148	0.04	14,203	307	13,479	15			62			1	1				
<b>TOTAL FOR MAP NO. 12</b>										<b>148</b>	<b>0.04</b>	<b>14,203</b>	<b>307</b>	<b>13,479</b>	<b>15</b>			<b>62</b>			<b>1</b>	<b>1</b>				
2017CPT.05.11.20922.1	Wake	13	SR 5204 - OLD BAUCOM RD	SR 2509 - MIAL PLANTATION TO SR 2542 - ROCK QUARRY RD	1	2		2.74	24	307	0.10	29,482	58	23,148												
<b>TOTAL FOR MAP NO. 13</b>										<b>307</b>	<b>0.10</b>	<b>29,482</b>	<b>58</b>	<b>23,148</b>												
2017CPT.05.11.20922.1	Wake	14	SR 1902 - CHEEK RD	SR 1901 - OLD WEAVER TRL TO DURHAM CO	1	2		0.14	24	16	0.01	1,506		1,109												
<b>TOTAL FOR MAP NO. 14</b>										<b>16</b>	<b>0.01</b>	<b>1,506</b>		<b>1,109</b>												
<b>TOTAL FOR PROJ NO. 2017CPT.05.11.20922.1</b>										<b>3,845</b>	<b>1.00</b>	<b>364,395</b>	<b>3,504</b>	<b>328,511</b>	<b>95</b>	<b>333</b>	<b>100</b>	<b>284</b>	<b>12</b>	<b>4</b>	<b>15</b>	<b>4</b>	<b>3</b>	<b>1</b>	<b>1,600</b>	<b>1,600</b>
<b>GRAND TOTAL</b>													<b>332,015</b>					<b>16</b>		<b>23</b>			<b>3,200</b>			

PROJECT NO.	SHEET NO.	TOTAL NO.
2017CPT.05.11.20922.1		

### THERMOPLASTIC AND PAINT QUANTITIES

PROJECT NO	COUNTY	MAP NO	ROUTE	DESCRIPTION	TYP	LANES	LANE TYPE	LENGTH	WIDTH	4810000000-E		4820000000-E	4825000000-E	4830000000-E	4835000000-E	4840000000-N		4845000000-N				4850000000-E	4860000000-E	4865000000-E	4870000000-E	4875000000-N				
										4" YELLOW PAINT	4" WHITE PAINT	8" YELLOW PAINT	12" YELLOW PAINT	16" WHITE PAINT	24" WHITE PAINT	PAINT MSG SCHOOL	PAINT MSG RXR	PAINT LT ARROW	PAINT STR ARROW	PAINT STR & RT ARROW	PAINT LT STR RT ARROW	4" LINE REMOVAL	16" LINE REMOVAL	8" LINE REMOVAL	12" LINE REMOVAL	24" LINE REMOVAL	REML OF PVMT MRKG SYMBOLS & CHARACTERS			
										LF	LF	LF	LF	LF	LF	EA	EA	EA	EA	EA	EA	LF	LF	LF	LF	LF	EA			
2017CPT.05.11.20922.1	Wake	1	SR 2300 - EDMONT RD	SR 2308 - FOWLER RD TO NC 97	1	2		5.59	17-34	49,842	58,881			82		100	12	EA		2					108,723			82	100	14
<b>TOTAL FOR MAP NO. 1</b>										<b>49,842</b>	<b>58,881</b>			<b>82</b>		<b>100</b>	<b>12</b>			<b>2</b>				<b>108,723</b>			<b>82</b>	<b>100</b>	<b>14</b>	
2017CPT.05.11.20922.1	Wake	2	SR 5270 - S FIRST AVE/BETHLEHEM RD	SR 2233 - SMITHFIELD RD TO SR 1007 - POOLE RD	1	2		2.77	20-34	30,014	31,212	48	135	100.00	80		4	EA	6	3	3				61,226	100	48	135	80	16
<b>TOTAL FOR MAP NO. 2</b>										<b>30,014</b>	<b>31,212</b>	<b>48</b>	<b>135</b>	<b>100</b>	<b>80</b>		<b>4</b>		<b>6</b>	<b>3</b>	<b>3</b>			<b>61,226</b>	<b>100</b>	<b>48</b>	<b>135</b>	<b>80</b>	<b>16</b>	
2017CPT.05.11.20922.1	Wake	3	SR 5270 - BETHLEHEM RD	SR 2511 - GRASSHOPPER RD TO SR 2509 - MIAL PLANTATION RD	1	2		1.97	20	16,784	21,328				16										38,112			16		
<b>TOTAL FOR MAP NO. 3</b>										<b>16,784</b>	<b>21,328</b>				<b>16</b>								<b>38,112</b>				<b>16</b>			
2017CPT.05.11.20922.1	Wake	4	SR 1381 - YATES MILL POND RD	SR 1379 - PENNY RD TO SR 1382 - OLDE SOUTH RD	1	2		1.87	24	19,073	19,500														38,573					
<b>TOTAL FOR MAP NO. 4</b>										<b>19,073</b>	<b>19,500</b>													<b>38,573</b>						
2017CPT.05.11.20922.1	Wake	5	SR 1001 - PEARCES RD	FRANKLIN COUNTY - TO NC 96 - N ARENDELL AVE	1	2		4.11	18-34	34,246	44,650	32													78,896		32			
<b>TOTAL FOR MAP NO. 5</b>										<b>34,246</b>	<b>44,650</b>	<b>32</b>											<b>78,896</b>		<b>32</b>					
2017CPT.05.11.20922.1	Wake	6	SR 1911 - MANGUM DAIRY RD	SR 1909 - PURNELL RD TO GRANVILLE COUNTY	1	2		2.09	20	21,552	21,566														43,118					
<b>TOTAL FOR MAP NO. 6</b>										<b>21,552</b>	<b>21,566</b>													<b>43,118</b>						
2017CPT.05.11.20922.1	Wake	7	SR 2700 - WHITE OAK RD	SR 2547 - WHITE OAK RD TO JOHNSTON COUNTY	1	2		2.6	22-34	30,165	27,856		116							6					58,021			116	6	
<b>TOTAL FOR MAP NO. 7</b>										<b>30,165</b>	<b>27,856</b>		<b>116</b>						<b>6</b>				<b>58,021</b>			<b>116</b>	<b>6</b>			
2017CPT.05.11.20922.1	Wake	8	SR 2320 - RILEY HILL RD	SR 2329 - LIZARD LICK RD TO NC 96 - N ARENDELL AVE	1	2		2.69	20	28,944	28,969														57,913					
<b>TOTAL FOR MAP NO. 8</b>										<b>28,944</b>	<b>28,969</b>												<b>57,913</b>							
2017CPT.05.11.20922.1	Wake	9	SR 1843 - MELVIN ARNOLD RD	SR 1842 - SHOOTING CLUB RD TO SR 1844 - MT.VERNON CHURCH RD	1	2		1.28	21	13,773	13,867														27,640					
<b>TOTAL FOR MAP NO. 9</b>										<b>13,773</b>	<b>13,867</b>												<b>27,640</b>							
2017CPT.05.11.20922.1	Wake	10	SR 1901 - OLD WEAVER TRL	SR 1902 - CHEEK RD BRIDGE JT TO NC 50 - CREEDMOOR RD	1	2		4.28	22	38,689	46,821				26										85,510			26	1	
<b>TOTAL FOR MAP NO. 10</b>										<b>38,689</b>	<b>46,821</b>				<b>26</b>							<b>1</b>	<b>85,510</b>				<b>26</b>	<b>1</b>		
2017CPT.05.11.20922.1	Wake	11	SR 1905 - WHITT RD	SR 1901 - OLD WEAVER TRL TO GRANVILLE COUNTY	1	2		0.88	22	9,293	9,293														18,586					
<b>TOTAL FOR MAP NO. 11</b>										<b>9,293</b>	<b>9,293</b>												<b>18,586</b>							
2017CPT.05.11.20922.1	Wake	12	SR 1923 - THOMPSON MILL RD	SR 5174 - OLD NC 98 HWY TO SR 1986 - MICA MINE LN (SKIP NC 98 INTERSECTION)	1	2		1.32	24	13,479	14,510	15			62					1		1			27,989		15	62	2	
<b>TOTAL FOR MAP NO. 12</b>										<b>13,479</b>	<b>14,510</b>	<b>15</b>			<b>62</b>				<b>1</b>		<b>1</b>		<b>27,989</b>		<b>15</b>	<b>62</b>	<b>2</b>			
2017CPT.05.11.20922.1	Wake	13	SR 5204 - OLD BAUCOM RD	SR 2509 - MIAL PLANTATION TO SR 2542 - ROCK QUARRY RD	1	2		2.74	24	23,148	29,540														52,688					
<b>TOTAL FOR MAP NO. 13</b>										<b>23,148</b>	<b>29,540</b>												<b>52,688</b>							
2017CPT.05.11.20922.1	Wake	14	SR 1902 - CHEEK RD	SR 1901 - OLD WEAVER TRL TO DURHAM CO	1	2		0.14	24	1,109	1,506														2,615					
<b>TOTAL FOR MAP NO. 14</b>										<b>1,109</b>	<b>1,506</b>												<b>2,615</b>							
<b>TOTAL FOR PROJ NO. 2017CPT.05.11.20922.1</b>										<b>34.33</b>	<b>330,111</b>	<b>369,499</b>	<b>95</b>	<b>333</b>	<b>100</b>	<b>284</b>	<b>12</b>	<b>4</b>	<b>15</b>	<b>3</b>	<b>4</b>	<b>1</b>	<b>699,610</b>	<b>100</b>	<b>95</b>	<b>333</b>	<b>284</b>	<b>39</b>		
<b>GRAND TOTAL</b>										<b>34.33</b>	<b>330,111</b>	<b>369,499</b>	<b>95</b>	<b>333</b>	<b>100</b>	<b>284</b>	<b>12</b>	<b>4</b>	<b>15</b>	<b>3</b>	<b>4</b>	<b>1</b>	<b>699,610</b>	<b>100</b>	<b>95</b>	<b>333</b>	<b>284</b>	<b>39</b>		

# SIGNING FOR RESURFACING PROJECTS

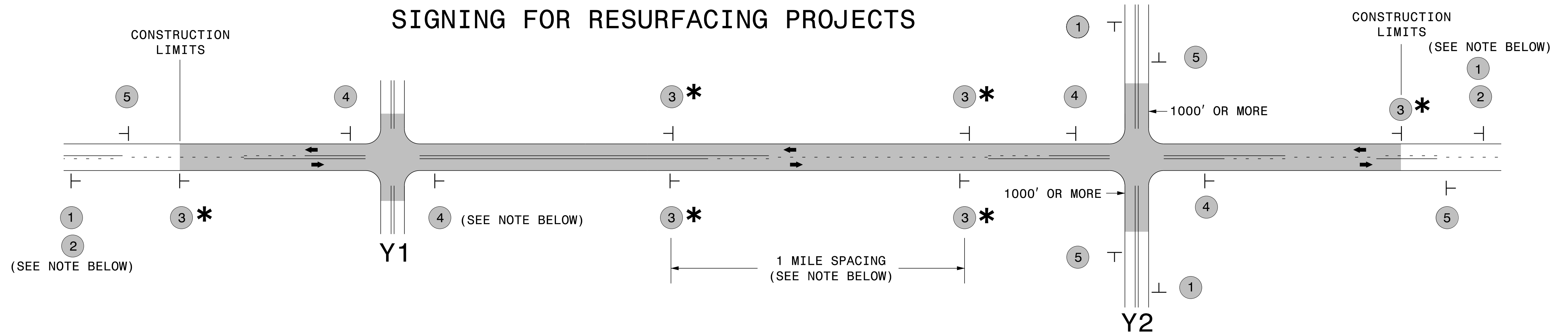

LEGEND	
┆	STATIONARY SIGN
←	DIRECTION OF TRAFFIC FLOW

## MAINLINE (-L-) SIGNING

## -Y- LINE SIGNING

SIGNING NOTES AND PLACEMENT PER DIRECTION	MAINLINE (-L-) SIGNING		-Y- LINE SIGNING	
	1	 W20-1 48" X 48"	PLACE 1000' PRIOR TO BEGINNING OF CONSTRUCTION LIMITS. ONLY USED ON -Y- LINES IF RESURFACING LIMITS EXTEND 1000' ALONG -Y- LINE.	<p>NO REQUIRED STATIONARY SIGNING FOR THE FOLLOWING -Y- LINE CONDITIONS:</p> <ol style="list-style-type: none"> <li>1) LESS THAN 1000' OF RESURFACING ALONG -Y- LINE</li> <li>2) SUBDIVISION ROADS</li> <li>3) DEAD END ROADS</li> </ol> <p>WHEN PAVING/CONSTRUCTION ACTIVITIES PROCEED ACROSS AN UNSIGNED -Y- LINE, ADVANCE WARNING PORTABLE SIGNS SHALL BE USED ALONG THE -Y- LINE AS SHOWN BELOW. REMOVE UPON COMPLETION OF WORK.</p> <div style="display: flex; justify-content: space-around;"> <div style="text-align: center;">             W20-1            48" X 48"         </div> <div style="text-align: center;">             W20-7 A            48" X 48"         </div> </div> <p>PLACED 500' IN ADVANCE OF FLAGGER. PLACED 250' IN ADVANCE OF FLAGGER.</p>
	2	 W7-3aP 24" X 18"	#2 SIGN ONLY USED WHEN RESURFACING LIMITS ARE 2 OR MORE MILES IN LENGTH. ROUND UP TO NEXT WHOLE NUMBER. (NO FRACTIONAL OR DECIMAL NUMBERS)	
	3 *	 SP 13107 48" X 48"	PLACE INITIALLY AT THE CONSTRUCTION LIMITS AND SPACED 1 MILE APART THEREAFTER. IF NO -Y- LINES EXIST, PLACE 2ND SET 1/2 MILE FROM THE CONSTRUCTION LIMITS AND THEN SPACE 1 MILE THEREAFTER.	
	4	 SP 13106 48" X 48"	THESE ARE FOR -Y- LINES THAT ARE "THROUGH" ROADWAYS. DEAD END AND SUBDIVISION ROADS ARE NOT "THROUGH" ROADWAYS. INSTALL 500' +/- FROM EACH -Y- LINE APPROACH AS SHOWN ABOVE. FOR MULTIPLE -Y- LINES THAT ARE SEPARATED BY 0.25 MILES OR LESS, TREAT AS A SINGLE UNIT AND INSTALL WITHIN 500' OF EACH APPROACH. A MAXIMUM OF 2 SIGN SETS PER MILE. DO NOT INSTALL WHEN -Y- LINES ARE WITHIN 0.5 MILES FROM "END ROAD WORK" SIGN.	
5	 G20-2 A 48" X 24"	PLACE 500' FOLLOWING THE END OF CONSTRUCTION LIMITS.		

### \* SIGNING FOR ASPHALT SURFACE TREATMENTS (ONLY)

SUBSTITUTE LOW/SOFT SHOULDER SIGNS BY ALTERNATING THE FOLLOWING TWO SIGNS: STARTING WITH "UNMARKED PAVEMENT AHEAD" (SP 06026) FOLLOWED BY "LOOSE GRAVEL" (W8-7).

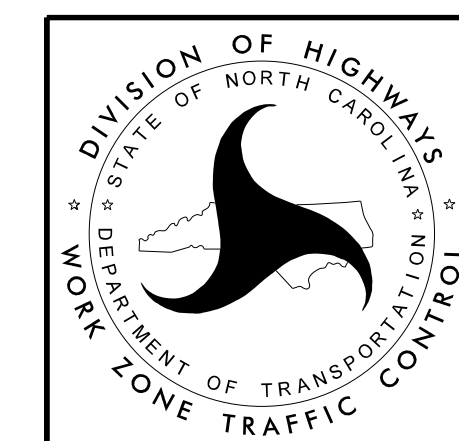

RESURFACING  
ADVANCE WARNING SIGNS  
FOR  
RURAL AND SUBURBAN  
2 LANE ROADWAYS